



# WAIVER REQUEST FORM

DPH – CQAC – DHCQ, 99 Chauncy Street, 2nd Floor, Boston, MA 02111

All waiver requests regarding a PHYSICAL PLANT REQUIREMENT MUST BE ACCOMPANIED BY REDUCED PLANS on 8½" x 11" sheets for clarification of specific physical plant condition to be waived. Physical plant waiver requests received without accompanying plans will be returned as "DENIED".

NOTE: A SEPARATE WAIVER REQUEST FORM MUST BE SUBMITTED FOR EACH REQUIREMENT FOR WHICH A WAIVER IS REQUESTED.

PLANNED PARENTHOOD LEAGUE OF MASSACHUSETTS

Facility's Licensed Name or Proposed Name

Address, including zip code

WORCESTER HEALTH CENTER, 470 PLEASANT STREET, WORCESTER, MA

If Hospital/Clinic Satellite, Name

Address, including zip code

N/A

Hospital/Clinic Department

Building/Floor Location

I HEREBY REQUEST THE DEPARTMENT WAIVE COMPLIANCE WITH THE REGULATION OR REQUIREMENT:

1.A: FOUND AT:

AIA Guidelines 2006, Section 3.7 - 1.6.1

(Regulation/Requirement Citation)

1.B: THAT REQUIRES (Text of Regulation/Requirement):

Four spaces shall be provided for each room routinely used for surgical procedures plus one space for each staff member. Additional parking spaces convenient to the entrance for pickup of patients after recovery shall be provided.

2.A: DESCRIPTION OF PROPOSED ALTERNATIVE TO COMPLIANCE WITH THE REQUIREMENT:

2.B: HOSPITALS AND LONG TERM CARE FACILITIES – WHAT WILL BE DONE TO COMPENSATE; CLINIC AND HOSPICE – HOW THE PROVIDER WILL REMAIN IN SUBSTANTIAL COMPLIANCE:

The plan provides 47 parking spaces, 17 more than the current Worcester facility. Overflow parking is available on surrounding city streets. In addition, the new central location for the facility provides bus and pedestrian access.

PLANNED PARENTHOOD LEAGUE OF MASSACHUSETTS, WORCESTER HEALTH CENTER

Facility's Licensed Name or Proposed Name

Address, including zip code

Regulation/Requirement Citation:

AIA Guidelines 2006, Section 3.7 - 1.6.1

3. PROVIDER'S EXPLANATION OF HOW MEETING THE REQUIREMENT AS WRITTEN WOULD CAUSE UNDUE HARDSHIP:

As a practical matter, no additional parking can be accommodated on the property. The site plan has been devised to maximize the parking count, including elevating the building to capture many surface spaces under the structure.

4. PROVIDER'S ASSURANCE THAT APPROVAL OF THE WAIVER: (A) WILL NOT LIMIT THE CAPACITY TO PROVIDE ADEQUATE CARE; AND, (B) DOES NOT JEOPARDIZE/AFFECT PATIENT OR RESIDENT HEALTH AND SAFETY:

The services provided in any exam/treatment room at Planned Parenthood create the demand for no more than 2 parking spaces at any time. As a result total demand for our facility would be 34 spaces (7 rooms x 2 spaces each, plus 20 spaces for each staff). Therefore our 47 parking spaces is more than adequate to provide convenient on-site parking for our patients.

FACILITY AUTHORIZED REPRESENTATIVE:

FACILITY CLINICAL REPRESENTATIVE:

Name: Dianne Luby
Title: President/CEO
Mailing Address: 1055 Commonwealth Ave
Boston, MA 02215

Name: Karen Y. Caponi
Title: Health Services Director
Tel #: 508-854-3300, ext. 1103

Signature: [Handwritten Signature]

Signature: [Handwritten Signature]

For DPH Use Only: The waiver identified above is approved, approved with conditions or denied as indicated below.

Evaluated by: [Signature] 06/09/08 [X] Approved [ ] Approved w/Conditions [ ] Denied

Reviewed by: [Signature] 6/12/08 [X] Approved [ ] Approved w/Conditions [ ] Denied

CONDITIONS:

Note: This waiver may be evaluated during on-site visits by Department staff at the facility. The Department reserves the right to revoke the waiver approvals if deficiencies are cited that indicate that the waivers adversely affect patient or resident health and safety.

PLEASANT

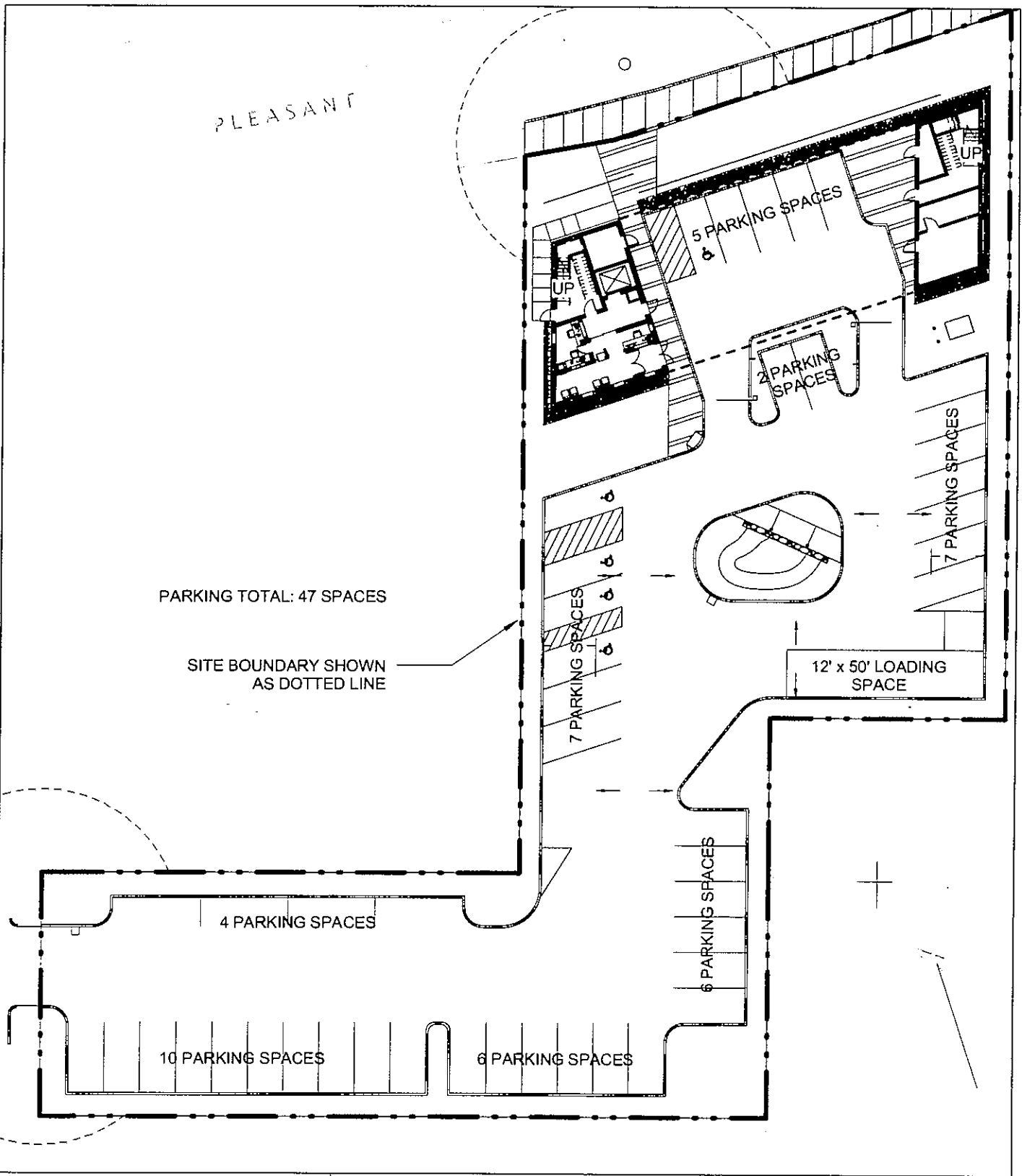

**ARCHITERRA**

PLANNED PARENTHOOD  
WORCESTER HEALTH CENTER

SITE PARKING WAIVER  
Section 3.7 - 1.6.1

Project number	2007-02
Date	FEBRUARY 15, 2008

<b>SK W-01</b>
Scale 1/32" = 1'-0"

3/19/2008 4:26:18 PM